

## Short Title

SR 372 (BALL GROUND ROAD) AT ETOWAH RIVER

## GDOT Project No.

642400-

## Federal ID No.

BRST-1022(10)

## Status

Programmed

## Service Type

Roadway / Bridge Upgrade

## Sponsor

GDOT

## Jurisdiction

Cherokee County

## Analysis Level

Exempt from Air Quality Analysis (40 CFR 93)

## Existing Thru Lane

2

## Planned Thru Lane

2

## Detailed Description and Justification

Replacement of the existing bridge on SR 372 over the Etowah River. This is a safety upgrade and the bridge will remain 2 lanes.

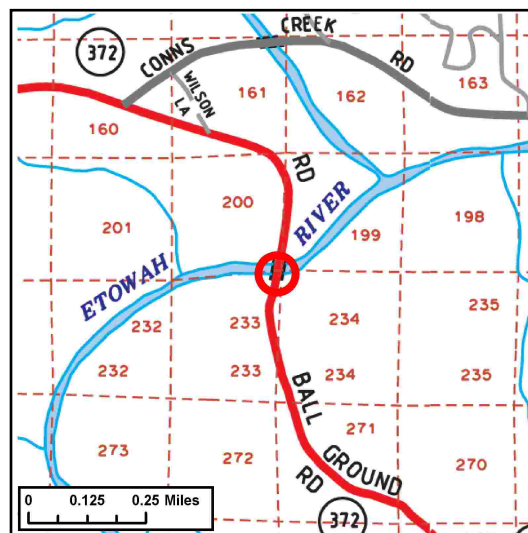

Copyright 2005 Aero Surveys of Georgia, Inc. Reproduced by permission of the copyright owner. Contact <http://www.aerotlas.com>

## Network Year

2020

## Corridor Length

0.7 miles

Phase Status & Funding Information		Status	FISCAL YEAR	TOTAL PHASE COST	BREAKDOWN OF TOTAL PHASE COST BY FUNDING SOURCE			
					FEDERAL	STATE	BONDS	LOCAL/PRIVATE
PE	Bridge (On-System)	AUTH	2002	\$0,000	\$0,000	\$0,000	\$0,000	\$0,000
PE	STP - Statewide Flexible (GDOT)		2014	\$5,000	\$4,000	\$1,000	\$0,000	\$0,000
ROW	Bridge (On-System)	AUTH	2013	\$530,000	\$424,000	\$106,000	\$0,000	\$0,000
CST	STP - Statewide Flexible (GDOT)		2014	\$4,308,555	\$3,446,844	\$861,711	\$0,000	\$0,000
				<b>\$4,843,555</b>	<b>\$3,874,844</b>	<b>\$968,711</b>	<b>\$0,000</b>	<b>\$0,000</b>

SCP: Scoping PE: Preliminary engineering / engineering / design / planning PE-OV: GDOT oversight services for engineering ROW: Right-of-way Acquisition  
 UTL: Utility relocation CST: Construction / Implementation ALL: Total estimated cost, inclusive of all phases



For additional information about this project, please call (404) 463-3100 or email [transportation@atlantaregional.com](mailto:transportation@atlantaregional.com).

